

# epicstudios

## VENUE PACK

FOR PROMOTERS, AGENTS, ARTISTS, EVENT ORGANISERS

UPDATED: APR 2024 \*Contact us for the full venue pack with prices included



[Venue Intro & Contacts](#)

[What's Included](#)

[Add-Ons](#)

[Venue Info & Requirements](#)

[Technical Specification](#)

[Parking & Maps](#)



Epic Studios is an exceptional multi-purpose venue that hosts live events from music to comedy to arena sports for audiences of up to 850, welcoming the most thrilling live acts from around the globe.

Our fully independent venue boasts a state-of-the-art 10,000 sq ft concert space, including world-renowned Martin Audio MLA sound system and industry-leading lighting featuring an Avolites D9 330 V16 control desk all looked after by a highly skilled technical team; the venue provides an experience that both performers and audiences agree is the best in East Anglia.

## STAFF CONTACTS

### Elise Gedge

Programmer & Events Manager

[elise.gedge@epic-tv.com](mailto:elise.gedge@epic-tv.com)

### James Wickham

Events & Marketing Assistant

[james.wickham@epic-tv.com](mailto:james.wickham@epic-tv.com)

### Alix Carter

Corporate Events Coordinator

[alix.carter@epic-tv.com](mailto:alix.carter@epic-tv.com)

### Harry Ross

Lighting Tech

[harry.ross@epic-tv.com](mailto:harry.ross@epic-tv.com)

### Dylan Barber

Sound Engineer

[dylan.barber@epic-tv.com](mailto:dylan.barber@epic-tv.com)



# WHAT'S INCLUDED

## PA & Monitoring

Martin Audio MLA FOH PA, Martin Audio LE200 Monitors

## Lighting, Video & SFX

Full specifications below

## Mojo Barrier

For standing shows only

## Tech Team

1 In House Audio Engineer & and 1 Lighting Engineer

## Duty Manager

Lead coordinator for event

## Backstage Dressing Rooms

Up to 4 dressing rooms, green room, shower facilities and additional changing space

## Parking

See map below

## Box Office

Ticket sales, scanning and guest list handling

## Security

Regency Security Group Norwich



# ADD-ONS

## Broadcast Filming Packages

Our event space doubles as a multi-cam TV broadcast studio. Have your event recorded by our talented broadcast team to be used for social media clips, music videos or tour promo; packages vary from a basic single camera shoot to full multi-camera coverage

[Click Here For More Info](#)



## Local Marketing Contribution

A small budget that we can use to assist with local marketing including social media ads, flyer distribution, animations on our digital screens, etc. Events with this contribution will receive marketing priority over those that don't

## Confetti Cannons

2x Magic FX Stadium Blaster

## Spark Generators

2x spark generators

## Bus Power

16A/32A single phase or 32A three phase power from 9am until venue lockup

## Towels

Shower towels and stage towels available

## Additional Crew Is Available Upon Pre-Arrangement

Load-in crew, monitor engineer, merch seller, etc.

\*Contact us for the full venue pack with prices included



# VENUE INFO & REQUIREMENTS

## ■ Ticketing

We require a minimum 50% allocation of the saleable capacity. We have partnered with Universe (Ticketmaster) to sell tickets for our events

## ■ Merchandise

We do not charge any merchandise fee, we will provide a merch area with tables and mesh wall racks. Merch sellers can be provided with prior arrangement

## ■ Age Restrictions

All ages welcome, under 14's must be accompanied by an adult over the age of 18. Please make us aware if your event is not suitable for children. Club nights must be 18+

## ■ Stage Rules

No smoking/vaping and no glass allowed on stage, no public indecency or sexual acts. We ask that performers show respect to our staff, security and customers



## ■ Noise Curfews

No show volume (pink noise and line checks only) pre 5pm on weekdays. No amplified sound beyond 11pm on weekdays. We can extend our licence for certain events with prior arrangement. Weekend events have no starting curfew, 100dB LAeq15 limit

## ■ Accessibility

The studio is on the first floor, there are multiple staircases and lifts available. If your event is standing, we will mark off a section of the room for disabled seating

## ■ Bars

We operate two bars in our venue. One located outside the main studio that is open pre-event, and one located within the studio that is open during the event. We request that both bars remain open during your event

## ■ Photography

We work with a number of local photographers, please let us know if your event has any restrictions in regards to photography. We will happily share the photos with you post-event



## TECHNICAL SPECIFICATION

### ■ Rigging

**Clearance** - 6m from Studio floor to Fly points (minimum), 7m From studio Floor to Fly points (maximum)

**Rated Flying Weight** - 1 beam rated flying weight 300kg UDL

**Pantographs And Truss** - 170 Motorised pantographs at a SWL of 37kg as well as various lengths of truss raised by manual chain hoists

### ■ Staging

**Stage Type** - Steeldeck 8' x 4' x 12, Hexadeck 8' x 4' x 10,

**Height** - 1m

**Stage Standard Dimensions** - 12m width x 4.8m depth

**Barrier** - Steel Mojo Barrier 1m x 28, Aluminium Crowd Barrier 2m x 20

**Lightspace Deck** - Up to 12m x 6.8m, incurs additional cost and will reduce capacity

### ■ Power

125A Three Phase Ceeform (Located at rear of studio, 35m to stage)

2X 63A Single Phase Ceeform

2X 32A Three Phase Ceeform

16A Single Phase Ceeform

13A Sockets

(Note we do not have 63A 3ph)

(See studio plot for locations)



## ■ PA

Martin Audio MLA Compact x12

Martin Audio DSX 2 x 18" Subs x8

Martin Audio CDD-LIVE 15 x2

Removal of house PA for visiting systems will be charged to the hirer to cover labour costs of de-rigging and re-rigging the house system

## ■ Monitoring

Martin Audio LE200 x8

Martin Audio CDD-LIVE 15 x1

## ■ Audio Control

Allen & Heath dLive S7000

Allen & Heath SQ7

## ■ Digital Multicore

Allen & Heath DM48 48 channel MixRack

Equipped with DANTE, gigaACE and MADI option cards for digital splits.

A 24 way analogue split can be provided if needed.

## ■ Health & Safety

PAT Testing - All equipment brought into Epic Studios must have a current Portable Appliance Test (PAT) certification. Epic Studios' management reserve the right to refuse permission for event organisers to use equipment if a valid certificate cannot be produced. All materials brought into the venue must be fireproofed

## ■ Microphones

**Shure** - SM57 x4, Beta58 x3, SM58 x5, Beta91, Beta 52A, Beta56A x2, KM141

**Sennheiser** - E604 x4, SKM 5200-II BK-L Wireless x2, MD421 x2 AKG: C451B, C460 B x2, C414 x4

**Audix** - D2 x2, i5, D4, D6

**Beyerdynamic** - CK703 x3

**Stands** - Assorted tall & short stands by Beyer/K&M

**DI Boxes** - BSS AR133 x 6 Radial Pro D2 stereo passive x 1

## ■ Video Wall & Displays

**STAGE** - 30x 3.8mm pitch750x500mm led panels.

8x 3.8mm pitch 1000x500mm led panels

Novastar MCTRL4K controller

(5mx3m section flown upstage. 2x 2mx1m moveable panels on stage)

**Projection** - 3x Christie LWU 505 Projectors and screens.

**Bar Displays** - 18x NEC UNV464 LED Monitors, 20 x Martin LC 2140 LED Wall Panels

(Any consumables or additional rigging will be charged accordingly)

## ■ Load In/Out Info

Flat load in via large street level loading bay then five tonne goods lift directly to studio floor. See arrival map below.

Bus power is available, see above for rates.

Two members of venue technical staff will be on hand during your booking to assist with load in/out. Any further local crew can be arranged with prior arrangement

## ■ Lighting

**Control** - Avolites D9 330 V17, Avolites Q3 media server, Avolites TNP V17, Avolites Tiger Touch II – V15.1 plus side wing

**Dimming** - 360 x channels of ETC Sensor dimming available via motorised pantographs and wall patch boxes

**Generics** - 1k Studio Fresnel x30, 2k Studio Fresnel x20, 5k Studio Fresnel x20, Source 4 x4, Long Nose Par x20 – Available with 60,61,62,88 Lamps, Space Light 6000W x4

**Specials** - Robe T1 profile x12, Robe Robin 350 x20 Robe Tetra X x12, Vari VI1000 x4, Chauvet Led Spot 250 x4, Studio Due CS-4 x4, Chromlec Jarag 5 x8, Sunstrip x20, Philips SL e-strip 10 x12 – Available with or without barn doors

**Lasers** - Laserworld Tarm 6 (Upgraded to 60kkps) x2 20w FB4 Animation laser x4,

## ■ SFX

Martin Atomic 3000 Strobe x8

Unique Hazer 2.1 x2

Jem Glaciator x1

Jem ZR30 x1

Jem Stage Hazer x1

Chauvet Fun Fettig x2(Additional Charges Apply)

Spark Generators x2 (Additional Charges Apply)

MAGIC FX Stadium Blaster x2 (Additional Charges Apply)

■ [Click here to access 3D plots and tech files for touring techs](#)



# Arrival/Parking

Flat load in via large street level loading bay then five tonne goods lift one floor up directly to studio

Trucks/Buses should park on Edward Street facing away from entrance, loading bay has space outside for up to two splitter vans or one truck/lorry, nearby public car parks are open 24/7

# Studio Layout

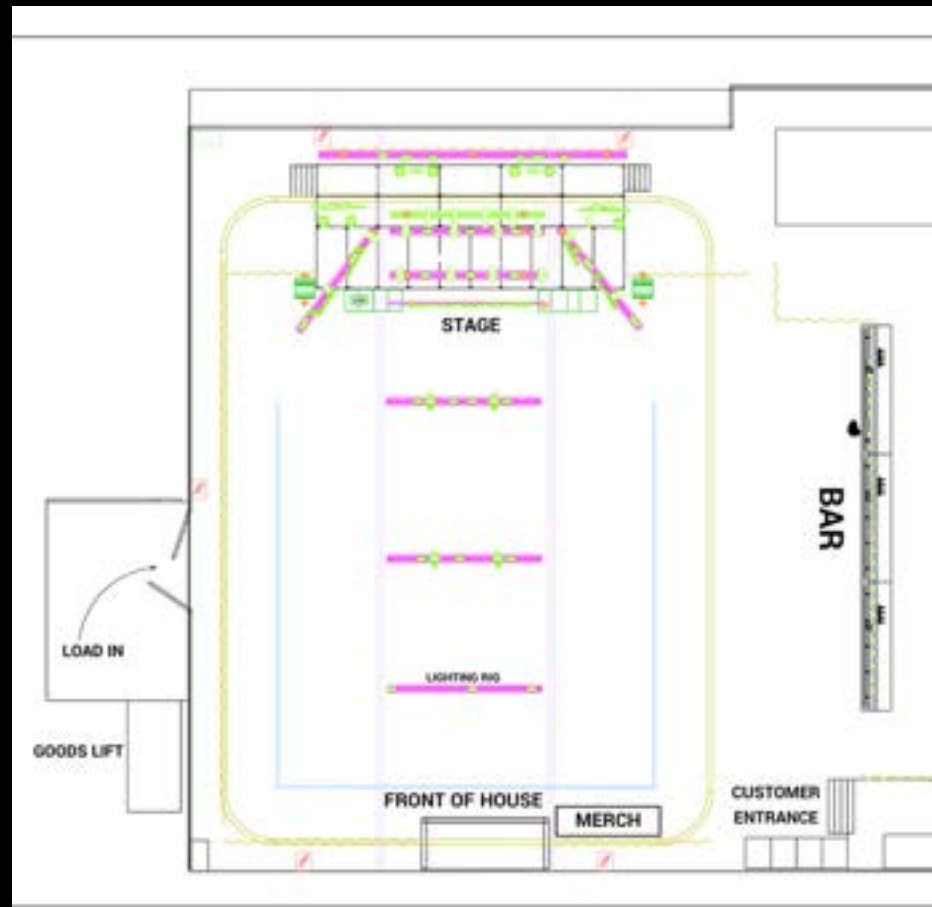



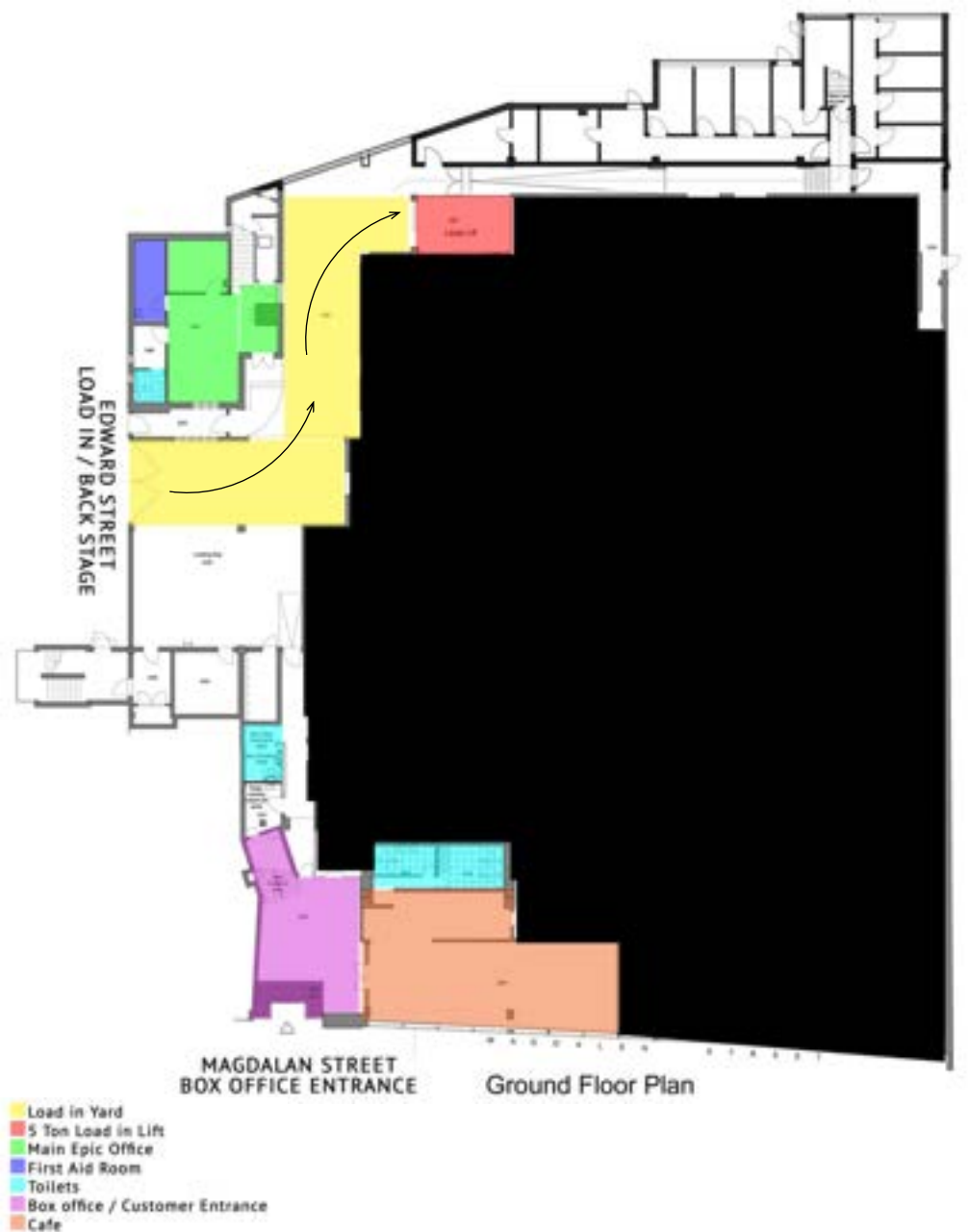

Ground Floor

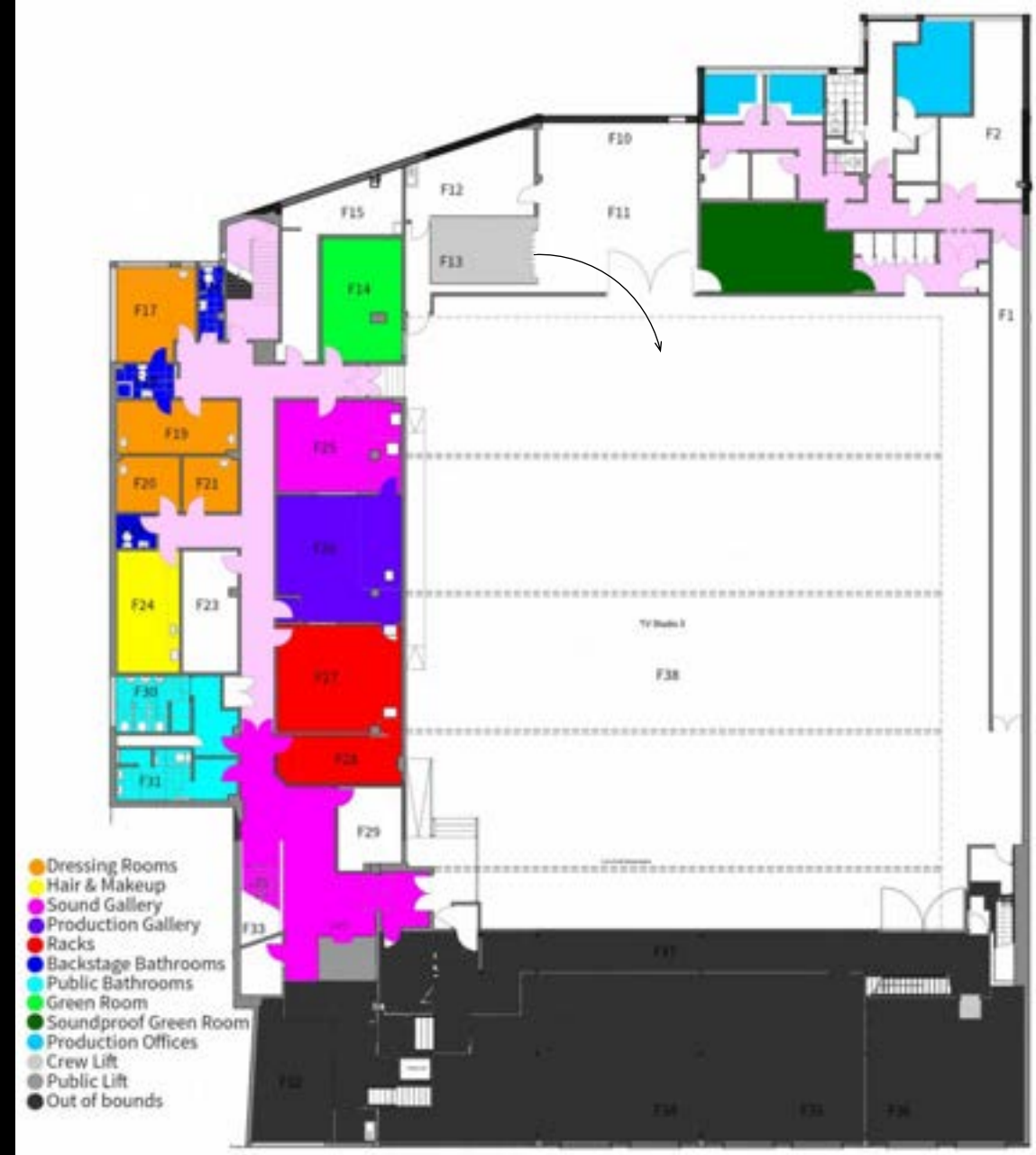

First Floor

Address: 112-114 Magdalen Street, Norwich, Norfolk, NR3 1JD